

Large Sensor to fit all Ellies/Efergy Wireless Energy Monitors

Product Code: FSEMMLS



- Wireless Energy Monitor Additional Sensor excluding software.

Large Sensor to fit all Ellies/Efergy Wireless Energy Monitors

Replacement sensor or upgrade your Ellies/Efergy monitor to allow connection to larger diameter cables up to 19mm.

Diagram

Attach the sensor

Pull the clasp to open the CT sensor. Place the sensor around the feed cable and push the clasp to shut. Insert the sensor jack into the base of the transmitter.

IMPORTANT - The CT sensor must be clamped around the LIVE wire only and not around a cable containing the live, neutral and earth wires.

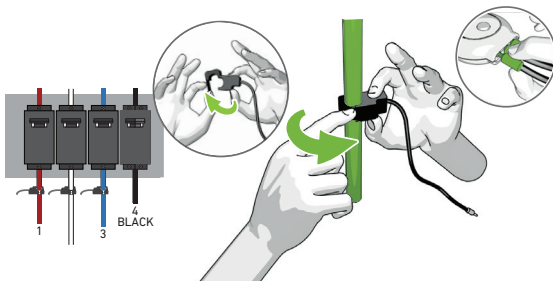

Link transmitter and display

Push the link button located on the back of the display unit. The link icon on the screen will flash. Press the button on the transmitter to complete synchronization. If the link is completed, you will see that the link icon is back on the screen.



Note: Monitors total power consumption of all three phases together.

TECHNICAL INFORMATION

Specifications:

Max. current:	140 Amp
Max. permitted cable diameter:	19 mm
Max. voltage:	600V
Measuring CAT II	



Caution: Turn off power before installing these devices. If you are concerned about installation please contact an electrician, ensure cables are not damaged. Do not cut cables.

THE PACKAGE CONTAINS



1 x Sensor unit

PACKAGING DIMENSIONS

	Weight (kg)	Height (mm)	Width (mm)	Depth (mm)
Package	0,02	3,7	10,9	24,3